

Explorer Pro Sound System Owners Manual

MADE IN USA



A Message from the President

Congratulations on purchasing an Anchor Audio sound system, the choice of thousands of satisfied customers including the White House, prestigious universities, school districts nationwide, police and fire departments, and all branches of the U.S. military. Our products are made of the finest materials and built with pride in the U.S.

We've incorporated the latest technology into your sound system yet kept it simple to use. Just take a few minutes to review this manual to ensure the maximum enjoyment of your Anchor system. Or, you can view a demonstration video complete with a trouble shooting section at www.anchoraudio.com.

Feel free to call our friendly customer support staff at 1-800-ANCHOR1 Monday thru Friday between 7:00am and 5:00pm Pacific Standard Time with any questions. We love to hear from our customers.

Janet Jacobs – President
on behalf of all Anchor Employees

CONTENTS

GETTING STARTED / WARRANTY INFORMATION.....	1
BASIC SYSTEM OPERATION / SPEAKER STAND SETUP.....	2
CONNECTING SOUND SYSTEM / CONTROLLING FEEDBACK.....	3
OPERATING THE BUILT-IN UHF WIRELESS RECEIVER / CERTIFICATION.....	4
OPERATING THE WIRELESS MICROPHONE / TRANSMITTER.....	5
CARING FOR YOUR BATTERY.....	6
HAVING TROUBLE WITH YOUR SOUND SYSTEM? / TECHNICAL SPECIFICATIONS.....	7

GETTING STARTED

Please check your new unit carefully for any damage which may have occurred during shipment. Each Anchor product is carefully inspected at the factory and packed in specially designed boxes for safe transport.

Notify the freight carrier immediately of any damage to the shipping box or product. Repack the unit in the original box and wait for inspection by the carrier's claim agent. Notify your dealer of the pending freight claim.

NOTE: All damage claims must be made with freight carrier!

RETURNING SYSTEMS FOR SERVICE OR REPAIR

For service or repair, please contact the dealer you purchased your system from or Anchor Audio Customer Service at 800.262.4671 to obtain a RA (Return Authorization) number. You may also complete an online RA request form at www.anchoraudio.com. All shipments to Anchor Audio must include a RA number and must be shipped prepaid. C.O.D. shipments will be refused and returned at your expense.

IMPORTANT: Save the shipping box & packing materials, they were specially designed to ship your unit!

WARRANTY REGISTRATION

Visit our website at www.anchoraudio.com and select "Warranty Registration." Complete the online form to activate the six-year limited warranty on your Explorer Pro sound system and two-year limited warranty for the microphones.

100-0172-000/A - 11/10

For System Setup & Operation Videos Visit Our Website: www.anchoraudio.com



BASIC SYSTEM OPERATION

NOTE: Fully Charge Batteries Before First Use!

1. Set all Input Level Controls to minimum & Tones Controls to flat or the middle setting before turning your system on
2. Plug a wired microphone into the MIC 1 or MIC 2 jacks and/or plug an audio source into the LINE-IN jack
3. Switch POWER to ON, the BATTERY LED will light
4. Slowly increase the Level Control for the input jacks used to the desired volume
5. Adjust BASS & TREBLE controls to desired sound quality

IMPORTANT: Make all connections with shielded cables to avoid hum, buzzing or interference.

SPEAKER STAND SETUP

1. Loosen the Lower Collar Knob
2. Separate the stand legs until the leg support Cross Braces are parallel to the floor
3. Tighten the Lower Collar Knob
4. Loosen the Upper Collar Knob and extend the center pole
5. Adjust height and retighten the Upper Collar Knob
6. Place your Anchor sound system on the stand

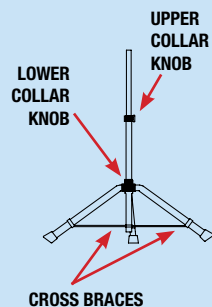

SPEAKER STAND ADAPTER

The 1.5" diameter Speaker Stand Adapter lets you mount the Explorer on a speaker stand.

1. Slide Speaker Stand Adapter into slot on Explorer PRO bottom
2. Tighten screw to secure adapter
3. Place unit on stand carefully
4. Tighten screw on Adapter collar securing Explorer PRO on stand

BACK PANEL OF EXP-7500U2

WIRELESS RECEIVERS 4
(see page 6)

RX INDICATOR LIGHTS FOR WIRELESS RECEIVER 1
A solid red light on one of the RX Indicator Lights indicates that the sound system is getting good reception with the wireless microphone
A solid red light on both RX Indicator Lights indicates that the sound system is at optimum reception with the wireless microphone

RX INDICATOR LIGHTS FOR WIRELESS RECEIVER 2

WIRELESS MICROPHONE 1 LEVEL CONTROL
Adjust knob to control wireless microphone levels

WIRELESS MICROPHONE 2 LEVEL CONTROL

AC POWER CORD INLET

POWER SWITCH

CHARGE INDICATOR LIGHT

BATTERY LEVEL INDICATOR LIGHT

LINE OUT - OUTPUT JACK
Balanced 1/4" – provides a combined output of all active system inputs
Record your presentation or connect to another powered sound system

LINE IN - INPUT JACKS
The 1/8" (3.5 mm) jack input is used to hook up an iPod, a portable CD/ MP3/ tape player, laptop computer, or similar external audio source
The 1/4" unbalanced input can be used for other communication devices including a mixer or daisy chaining together multiple Explorer speakers

LINE IN LEVEL CONTROL

TONE CONTROLS - BASS/TREBLE

WIRED MIC LEVEL CONTROLS

MUSIC/ SPEECH BUTTON
In situations where you're speaking to a larger crowd or in a noisy environment, just push the Music/Speech button in and give your voice an added boost
To return back to normal use, just push the Music/Speech button again

VOICE OVER BUTTON
Push the "Voice Over" button in to have the music automatically lowered when you speak through a connected microphone
Music will return to original level when mic use/speaking stops

SPEAKER OUT - OUTPUT JACK
Connect the system to a Explorer PRO unpowered companion speaker



CONNECTING TWO OR MORE EXPLORER PRO SOUND SYSTEMS

USING A EXPLORER PRO UNPOWERED COMPANION SPEAKER (EXP-7501)

Connect one end of a speaker cable (SC-50NL) to the SPEAKER OUT jack on the back of a powered Explorer PRO sound system. Connect the other end to the jack labeled IN on the back of a Explorer PRO unpowered companion speaker.

NOTE: AC power is not required for an unpowered companion speaker.

USING 2 POWERED EXPLORER PRO SOUND SYSTEMS

This method uses the line-output feature of your Explorer PRO sound system. Connect a speaker cable (1/4" phone) from the LINE OUT jack on the first powered Explorer PRO to the LINE IN jack on the second powered Explorer PRO. Set the volume of the second Explorer PRO to maximum so that full volume control will be at the first or primary sound system.

NOTE: The line-output feature can also be used to send the signal to a sound system in a different room or a separate recording device.

SETTING UP YOUR EXPLORER PRO SOUND SYSTEM

We recommend placing your sound system between the audience and the presenter, facing the audience and raised above their heads using a speaker stand or table. This benefits listeners in the rear of the crowd, minimizes the risk of overpowering those in the front and helps prevent feedback by keeping microphone users behind the sound system.

SINGLE SYSTEM PLACEMENT

Place your unit along the least trafficked aisle pointing towards the center of the audience.

MULTIPLE SYSTEM PLACEMENT

Place units along aisles pointing just off the audience center line, over the crowd's head. With the sound system placed properly it should provide sufficient coverage.

CORRECT SYSTEM PLACEMENT

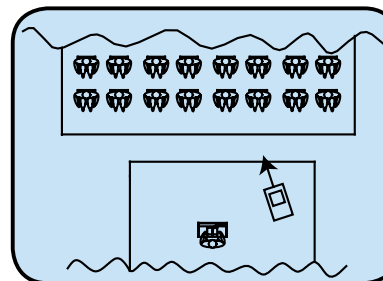

WRONG SYSTEM PLACEMENT

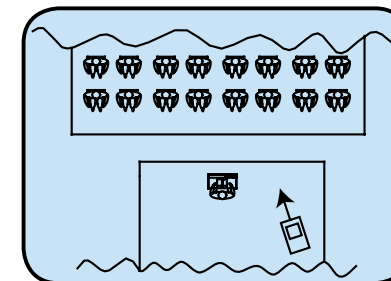

CONTROLLING FEEDBACK

Feedback, a howling noise or shrill sound, is self-generated by the sound system. It's caused by a microphone picking up the sound coming from the speaker and then re-amplifying it. Once a feedback loop starts it continues until the system is adjusted.

FEEDBACK CAUSES

- Microphone too close, pointing towards or in front of speaker
- Volume setting is too loud for room
- Sound reflecting off hard surfaces

AVOIDING & ELIMINATING FEEDBACK

- Point microphone in a different direction
- Keep microphone away from the speaker
- Place speaker in FRONT of the microphone
- Reduce the sound system volume levels

CAUTION: Feedback can damage your equipment & may be hazardous to hearing.

DIVERSITY WIRELESS BY ANCHOR AUDIO

Anchor Audio UHF wireless is a 16 channel, diversity wireless system that receives signals with two independent antennae. With diversity wireless the receiver processes the stronger signal, effectively minimizing dropouts and interference from other transmitting sources. The antennae are mounted internally so there are no obstructions or risk of damage.

CHANNEL SELECTION - BUILT-IN RECEIVER

Select a channel, set the built-in receiver & microphone transmitter to that channel before using your wireless system.

1. Choose any available wireless channel/frequency from 1 thru 16
(see page 5 for transmitter instructions)
2. Set the Wireless Channel Selector Knob to the channel/frequency you choose in step 1

If you have two wireless receivers repeat above for the second receiver. Remember, each receiver/transmitter pair must be set to different channels to avoid interference.

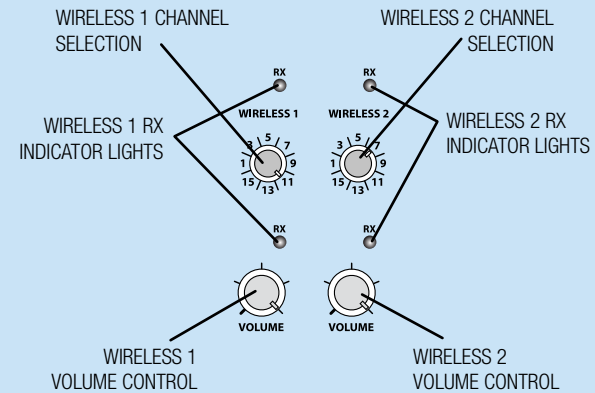

**NOTE: Ongoing wireless interference? The frequency you selected may be in use by other systems in the area!
Change channels until you find a clear frequency!**

CERTIFICATION

This system conforms to part 74 and part 15 of the FCC rules, contact the FCC office for filling forms.

Frequency Range: 682 MHz - 698 MHz

WH-6000EU and WB-6000EU transmitters meet the essential requirements of the European R&TTE Directive 99/5/EC and are eligible to carry the CE marking. CE 0336 (⚠)

European Frequency Range: 863.125 MHz - 864.875 MHz



OPERATING THE WIRELESS MICROPHONE/TRANSMITTER

CHANNEL SELECTION - HANDHELD TRANSMITTER

1. Unscrew battery cover on bottom of microphone
2. Set the CHANNEL SELECTOR dial to match the channel setting of your receiver
3. Replace battery cover and tighten firmly

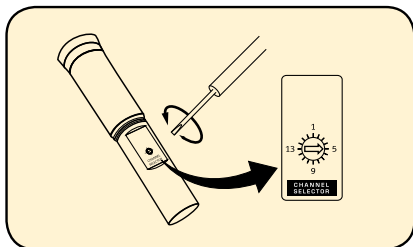

CHANNEL SELECTION - BODY-PACK TRANSMITTER

1. The channel selection dial is located on the side of the transmitter
2. Set the CHANNEL selection dial to match the channel setting of the receiver

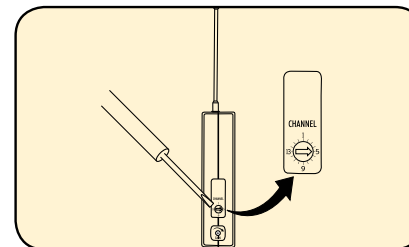

NOTE: When using dual wireless, each microphone must be set to a different channel!

USING YOUR WIRELESS MICROPHONES

After you have set the transmitter channel (see above) you are ready to use your wireless microphone:

1. Body-pack transmitter users must insert the mic plug into the transmitter jack marked MIC
2. Turn the transmitter power switch to ON
(The red LED will flash when the mic is turned on. If the red LED stays on, the battery is low)
3. Turn the Explorer Pro power switch to ON
4. The RX indicators will light *(only one indicator will light at a time)* when the wireless signal is being transmitted and received

CAUTION: Harmful feedback may occur when walking in front of a sound system or speaker with a wireless microphone. Always point microphone away from speakers!

REPLACE BATTERY - HANDHELD TRANSMITTER

1. Unscrew battery cover on bottom of microphone
2. Replace old batteries with two fresh size 'AA' alkaline batteries
3. Replace battery cover and tighten firmly

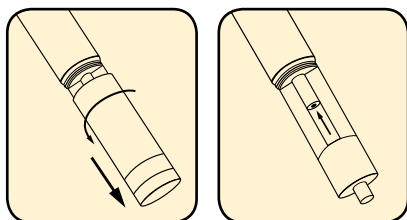

REPLACE BATTERY - BODY-PACK TRANSMITTER

1. Slide open battery cover on front of transmitter
2. Replace old batteries with two fresh size 'AA' alkaline batteries
3. Replace battery cover by sliding firmly into place

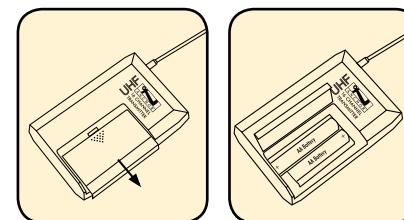

NOTE: Transmitter power must be OFF when changing batteries!



CARING FOR YOUR BUILT-IN BATTERY

An automatic charging system is built-in to your Explorer PRO Sound System. It is designed to properly charge and maintain the systems built-in battery.

CHARGING THE BATTERY

1. The Battery Level Indicator Light will show a flashing red light when battery is low
2. To charge the battery, plug the AC power cord into the Explorer PRO
3. Plug the other end of the cord into AC outlet
4. The Charge Indicator Light will show flashing green light when charging is complete

To preserve the life of your battery it is recommended that it be fully charged as soon as possible after every use regardless of the length of operation.

NOTE: System Can Be Used While Battery Charges!

OPERATING IN AC MODE

Plug your sound system into an AC outlet. Operate the system normally while the built-in battery charges automatically. The Charge Indicator Light will show a solid green light when battery is charging and a flashing green light when charging is complete.

IMPORTANT: Always Store Your System with Battery Fully Charged!

CHARGE INDICATOR LIGHT

The Explorer PRO sound system is equipped with a built in rapid charger, designed to quickly charge and maintain the battery.

- GREEN (solid): Battery is in good condition, rapid charging has begun
- GREEN (flashing): Battery is fully charged

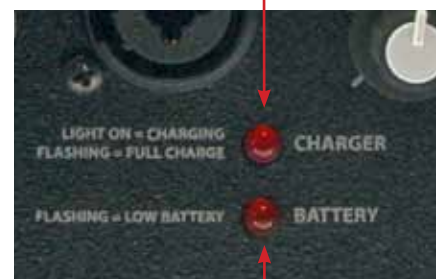

BATTERY LEVEL INDICATOR LIGHT

The Explorer PRO sound system features a built in Battery Level Indicator Light that shows the battery level in two steps at power on.

- RED (solid): Battery is ready for use
- RED (flashing): Battery level becoming low
(system auto-shut off in 45-60 minutes)

Waste electrical and electronic products must not be disposed of with household waste. Please recycle where facilities exist. Check with your Local Authority or Retailer for recycling advice.





SIX YEAR WARRANTY

HAVING TROUBLE WITH YOUR SOUND SYSTEM?

CONDITION	POSSIBLE SOLUTION
No Sound (<i>power LED off</i>)	<ul style="list-style-type: none"> • turn POWER switch ON • charge battery or plug in AC cord
Charge Indicator LED off No Sound (<i>power LED on</i>)	<ul style="list-style-type: none"> • leave plugged in for 48 hours to repair battery • check for output from source • make sure all cables are completely plugged in • turn up volume control of input used • remove plug from speaker output if not using external speaker output
Shortened Battery Life	<ul style="list-style-type: none"> • charge battery fully; if battery life continues to deteriorate, contact Anchor Audio customer service: 800.262.4671
Distorted Sound Excessive Hum or Noise	<ul style="list-style-type: none"> • lower system volume control • use shielded cables • use balanced microphone

HAVING TROUBLE WITH YOUR WIRELESS SYSTEM? (WIRELESS MODELS ONLY)

CONDITION	POSSIBLE SOLUTION
No Sound (<i>RX Indicator: ON</i>)	<ul style="list-style-type: none"> • set MUTE switch to on (<i>handheld mic only</i>) • turn up WIRELESS volume control • make sure mic is plugged into body pack transmitter
No Sound (<i>RX Indicator: OFF</i>)	<ul style="list-style-type: none"> • push mic power button • turn Explorer PRO POWER switch on • make sure transmitter power switch is on • set receiver and transmitter to same channel • replace battery in transmitter

NEED MORE HELP? View demonstration videos on proper system setup and operation at our website - www.anchoraudio.com

EXPLORER PRO TECHNICAL SPECIFICATIONS

Rated Power Output	75 watts AC / DC mode	Sensitivity For Rated Output	
Max SPL @ Rated Power	110 dB @ 1 meter	Line	-8.4 dBV (380 mVrms)
Frequency Response	80 Hz – 16 kHz	Mic (<i>unbal & bal</i>)	-49 dBV (3.63 mVrms)
AC Power Reqs.	90 – 264 VAC, 50/60 Hz	Outputs	
Dimensions (<i>HWD</i>)	16.5" x 10.5" x 10" (42 x 27 x 25 cm)	Line (<i>post fader</i>)	Lo-Z, buffered, 1/4" balanced
Weight	23 lbs / 10.4 Kg	Speaker	4-pole Neutrik Speakon® jack
Inputs			
Microphone	Lo-Z (1 k Ω), balanced, XLR		
(2 <i>combo jacks</i>)	12 VDC condenser mic phantom		
pwr			
Auxiliary	Hi-Z (10 K Ω), unbal, 1/4" phone		
	Hi-Z (10 k Ω), unbal, 1/8" & 1/4"		



(Specifications Subject to Change Without Notice)

ANCHOR AUDIO CUSTOMER SERVICE
800.262.4671

FOR ADDITIONAL INFORMATION
visit www.anchoraudio.com