

Juno™

Learning depends on listening and classrooms are inherently challenging environments for students to hear and for teachers to be heard. Improve your student's comprehension and learning outcomes with Juno.

This intelligent, all-in-one classroom audio solution has integrated Bluetooth® connectivity to provide rich audio amplification for both voice and media while being quick and easy to setup and use. Juno also supports remote and hybrid learning environments by seamlessly integrating with popular video conferencing solutions like Zoom®, Google Meet®, GoToMeeting® and more to bring the classroom to remote students and remote students into the classroom.

Juno Connect™ is a scalable solution that can meet the needs of both your classroom and campus. When used with FrontRow Conductor™, Juno enables campus communication functionality like intercom, paging, bell schedules and alerting. During an emergency, educators can speak directly with administrators or activate panic buttons using their smart microphones.



KEY FEATURES

- Three-speaker 2.1 stereo line array for 180° horizontal sound coverage
- Consistently rich sound with less volume drop-off over distance
- OptiVoice™ and Adapto™ optimize speech intelligibility while reducing feedback
- Voice-command control and automated lesson capture*
- Easy to move, set up and break down

**Requires FrontRow Teacher Edition™ Software*

Juno Tower

SPECIFICATIONS

Transmission type	Infrared
Receiving frequencies	2.1MHz, 2.4MHz; (2.8MHz, 3.3MHz, 3.6MHz with Channel Expansion Module)
Frequency response	50Hz – 20kHz
Signal-to-noise	>70dB
THD	<1% @ 1kHz
Maximum audio output power	40W, peak program
Power supply	18VDC @ 3.3AMP
Size (wxhxd)	Tower without base: 19.7 x 68.6 x 16.5cm / 7.75 x 27 x 6.5in Tower with base: 35.6 x 71.8 x 26.7cm / 14 x 28.25 x 10.5in
Weight	Tower without base: 5.7kg / 12.5lbs Tower with base: 6.4kg / 14lbs
Operating range	30.4m/100ft, line of sight (typical)
Sound Coverage Area	274.3m / 900ft ² (up to 487.6m ² /1600ft ² with speaker expansion)
IR Reception area	487.6m ² / 1600ft ² (typical)
Inputs	2 RCA jacks for external sensor connection 3 RCA stereo audio in jacks (with stereo sound output)
Outputs	3.5mm audio out jack



Teacher Microphone

SPECIFICATIONS

Transmission type	Infrared
Transmitting frequency	2.1MHz, 2.3MHz, 2.4MHz, 2.8MHz, 3.3MHz, 3.6MHz programmable
Frequency response	70Hz – 8kHz
Microphone	Unidirectional cardioid
Battery life	7 hours (typical)
Battery type	Li-Ion, 3.7V, 850mAH
Operating range	30.4m/100ft, line of sight (typical)
Inputs	3.5mm aux input
Outputs	Charge/programming jack
Size (wxhxd)	7.4 x 6.6 x 1.3cm / 2.9 x 2.6 x 0.5in
Weight	73.7g / 2.6oz (with battery and lanyard)



USER CONTROLS

When Pendant Mic is in standby mode:

Press momentarily	Wake
-------------------	------

When Pendant Mic is active:

Press momentarily	Mute/Un-mute
Press and hold	Issue Voice Command or trigger an alert or call the front office

Student Microphone

SPECIFICATIONS

Transmission type	Infrared
Transmitting frequency	2.1MHz, 2.3MHz, 2.4MHz, 2.8MHz, 3.3MHz, 3.6MHz programmable
Frequency response	70Hz – 8kHz
Microphone	Unidirectional cardioid
Battery life	7 hours (typical)
Battery type	Li-Ion, 3.7V, 850mAH
Operating range	21.3m / 70ft, line of sight (typical)
Input	3.5mm aux input
Output	Charge/programming jack
Size (wxhxd)	3.8 x 14.7 x 2.2cm / 1.5 x 5.8 x 0.85in
Weight	70.8g / 2.5oz



PUSH-TO-TALK SWITCH

Press and hold	Push-to-talk
Press and slide up	Power on

Microphone Charger

SPECIFICATIONS

Size (wxhxd)	8.9 x 4.6 x 11.4cm / 3.5 x 1.8 x 4.5in
Weight	226.7g / 8oz
Power supply	5.9V dc



Channel Expansion Module

Allows up to three additional student mics.

SPECIFICATIONS

Receive Frequencies	2.8MHz, 3.3MHz, 3.6MHz
Signal-to-noise	>70dB
THD	<1% @ 1kHz



Page Override Module

Automatically mutes Juno during a page or announcement.

SPECIFICATIONS

P.A. Input	Captive screw terminal magnetic coupling
Sensitivity	70mVrms (minimum)
Delay	<500mSec to >5Sec

INPUTS

Time Delay Control

Sensitivity Control

Captive Screw Terminal

Inductive Coupler



Speaker Expansion Module

Allows two additional ceiling speakers for larger rooms.

SPECIFICATIONS

Frequency Response	50Hz – 20kHz
THD	<1%
Maximum audio output power	2x8w (8Ω), 2x16w (4Ω)

INPUT

Captive Screw Terminal



Video Conference Cable Kit

Connects Juno inputs and outputs to integrate classroom voice and media audio with video conferencing platforms like Zoom, Google Meet, GoToMeeting and more. Only a single USB cable to the teacher's computer is required.

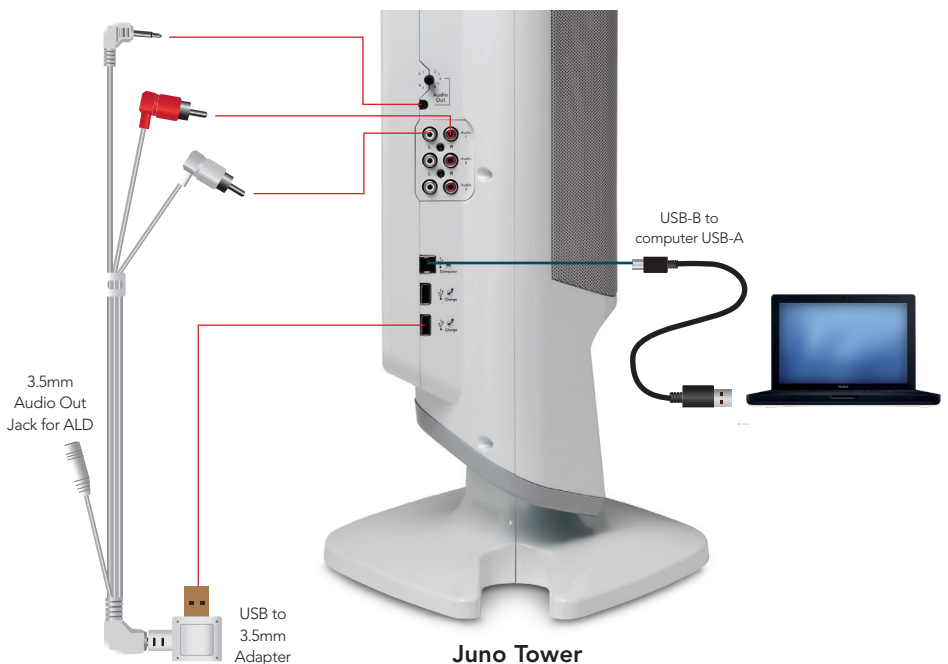



Learn more at [**gofrontrow.com**](https://gofrontrow.com)